

- NOTES:**  
 TO BE READ IN CONJUNCTION WITH SERVICES, STRUCTURAL & CIVIL DOCUMENTATION. ANY DISCREPANCY TO BE BROUGHT TO THE ATTENTION OF JACOBS.
- LEGEND:**
- XX EXISTING BUILDINGS TO BE RETAINED BUILDING NUMBER
  - [Red dashed line] EXISTING BUILDINGS TO BE DEMOLISHED
  - [Blue dashed line] DEMOLITION OF EXISTING BUILDINGS APPROVED UNDER A SEPARATE REF & IS NOT SOUGHT UNDER THE SSDA
  - [Cross-hatch pattern] EXISTING UNDERGROUND SERVICE TUNNEL - TUNNEL TO REMAIN, SERVICES TO BE CUT AND TERMINATED TO ENGINEERS DOCUMENTATION
  - [Pink box] EXISTING MAJOR SERVICES TO BE RETAINED. EXACT LOCATION TO BE CHECKED ON SITE
  - [Green circle with 'X'] EXISTING TREE - PROTECT WHERE ADJACENT TO CONSTRUCTION SITE DURING CONSTRUCTION WORKS
  - [Blue circle with 'X'] MAJOR EXISTING TREE TO BE REMOVED
  - [Green dashed line] ACCESS ROUTE MUST BE KEPT ACCESSIBLE UNTIL LATER STAGE OF THE PROJECT DEMOLITION. ALLOW / MANAGE DELIVERIES PRIOR TO CONSTRUCTION OF THE TEMPORARY LOADING DOCK

REV	DATE	DRAWN	REV'D	APP'D	AMENDMENT
4	11.07.18	BY	WB		REVISED FOR SSDA
3	05.07.18	MW	WB		ENABLING WORKS UPDATE
2	08.06.18	BY	WB		ISSUED FOR SUBMISSION
1	12.04.18	BY	WB		ISSUED FOR SSDA

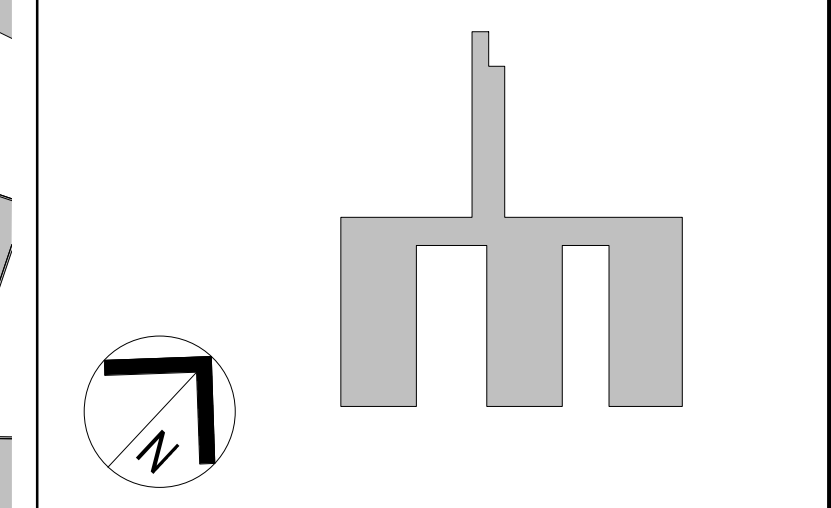

LEVEL 7, 177 PACIFIC HIGHWAY  
 NORTH STONEY  
 NEW SOUTH WALES  
 AUSTRALIA  
 TEL: +61 2 9528 2100  
 FAX: +61 2 9528 2110  
 WEB: jacobson.com

PROJECT  
**CONCORD HOSPITAL REDEVELOPMENT STAGE 1**  
 HOSPITAL ROAD  
 CONCORD NSW 2139

TITLE  
**DEMOLITION PLAN**

DRAWING STATUS	
DRAWN GA/MW/MR/EF	DRAWING CHECK PC/WB
DESIGNED AC/DG	DESIGN REVIEW CY
REVIEWED	DATE
APPROVED	DATE
SCALE 1 : 750	
PROJECT NO. IA064700	DRAWING NO. NEWB-AR-DRG-0002
REV	4

12/07/2018 9:06:16 AM

EXISTING BUILDINGS TO BE DEMOLISHED FOR NEW CLINICAL SERVICES BUILDING (SHOWN FOR REFERENCE ONLY - DEMOLITION OF THESE BUILDINGS HAVE BEEN APPROVED UNDER A SEPARATE REF & IS NOT SOUGHT UNDER THE SSDA)

ACCESS TO HELIPAD IS TO BE MAINTAINED AT ALL TIMES, INCLUSIVE OF AMBULANCE ACCESS FROM HELIPAD TO EMERGENCY DEPARTMENT