



1 IPU 1 - EAST ELEVATION
1:200



2 IPU 2 - WEST ELEVATION
1:200

NOTES:
TO BE READ IN CONJUNCTION WITH SERVICES, STRUCTURAL & CIVIL DOCUMENTATION. ANY DISCREPANCY TO BE BROUGHT TO THE ATTENTION OF JACOBS.

- ELEVATION LEGEND:**
- FAC1 TERRACOTTA CLADDING
 - FAC2 ACRYLIC RENDER FACADE SYSTEM (STO)
 - FAC3 ALUMINIUM NON-COMPOSITE CLADDING
 - FAC5 FRAMED GLAZING (WHITE / TURQUOISE / GREY DENOTES COLOURBACK PANEL)
 - FAC6 CURTAIN WALL GLAZING, EXTRUDED ALUMINIUM FRAME (WHITE DENOTES COLOURBACK PANEL)
 - FAC7 CURTAIN WALL (CURVED TRANSOMS + GLAZING) VERTICALS: SILICONE/UNCAPPED HORIZONTALS: CAPPED
 - FAC8 FIXED GLASS BALUSTRADE SCREEN WITH HIGH LEVEL CLEAR GLASS OPERABLE LOUVRES
 - FAC9 FRAMELESS FIXED GLAZING
 - FAC10 METAL SHEET CLADDING (COLORBOND)
 - FR1 FLAT ROOF, MEMBRANE WITH SELECT PAVERS/BALLAST
 - MR1 METAL ROOF SHEETING WITH 100mm INSULATION ROOF RAISERS
 - LVR1 HORIZONTAL LOUVRES

REV	DATE	ISSUED BY	APPD	REVISION
14	13.07.18	BY WB		ISSUED FOR COORDINATION
13	22.06.18	BY WB		MAIN WORKS 70% SD ISSUE
12	12.04.18	BY WB		ISSUED FOR SDA
11	29.03.18	MW/EF/ST/MS/AY/LVD		SCHEMATIC DESIGN ISSUE
10	16.03.18	MW/EF/ST/MS/AY/LVD		SCHEMATIC DESIGN DRAFT ISSUE
9	23.02.18	MW/WR/ST/MS/AY/LVD		MAIN WORKS 70% SD ISSUE
8	10.11.17	GA/CY		COMBINED STAGE 1A & 1B UPDATE
7	15.02.17	GA/CY		SCHEME DESIGN UPDATE
6	01.07.16	GA/CY		100% SCHEME DESIGN FINAL ISSUE
5	17.06.16	JS/CY		100% SCHEME DESIGN ISSUE
4	10.06.16	AF/CY		SCHEME DESIGN DRAFT ISSUE
3	10.06.16	JS/CY		SCHEME DESIGN DRAFT ISSUE

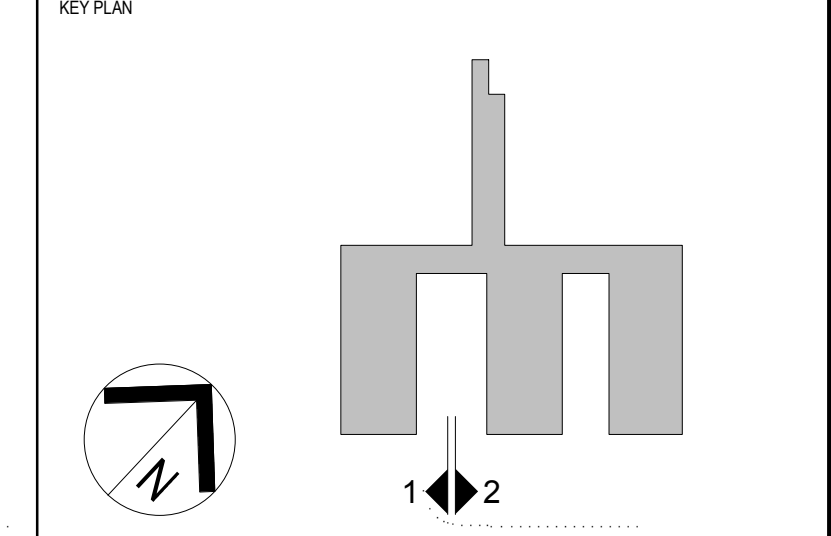

LEVEL 7, 177 PACIFIC HIGHWAY
NORTH STONEY
NSW 2139
AUSTRALIA

TEL: +61 2 9628 2100
FAX: +61 2 9628 2010
WEB: jacobsc.com

PROJECT
**CONCORD HOSPITAL
REDEVELOPMENT STAGE 1**

HOSPITAL ROAD
CONCORD NSW 2139

TITLE
**ELEVATION - IPU 1 EAST & IPU 2
WEST**

DESIGN DEVELOPMENT

DRAWN MW/BY	DRAWING CHECK PC/WB
DESIGNED AC/DG	DESIGN REVIEW CY
REVIEWED	DATE
APPROVED	DATE
SCALE 1:200	
PROJECT No. IA064700	DRAWING No. NEWB-AR-DRG-7003
REV	14

13/07/2018 6:37:28 PM