

EXISTING

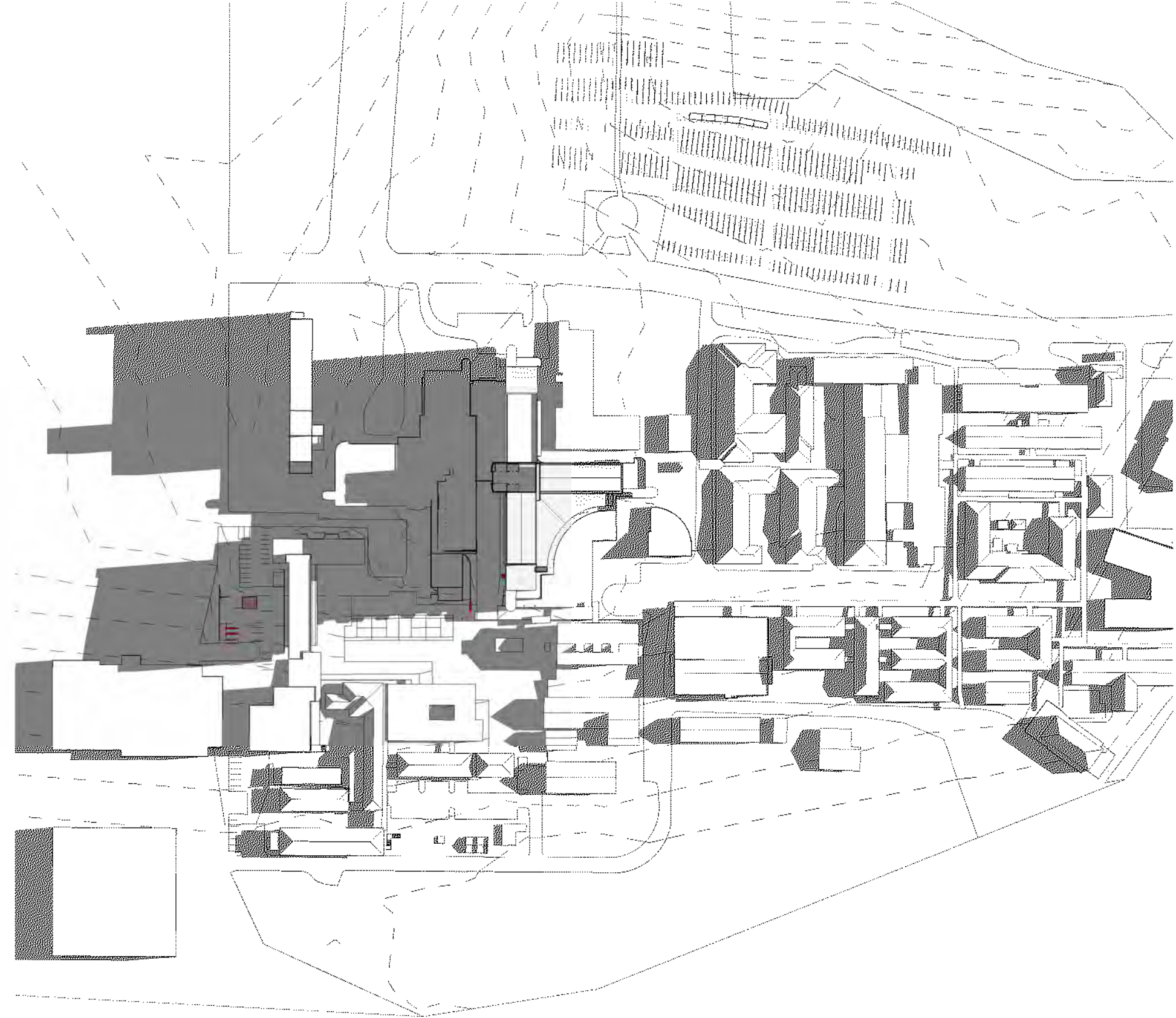

WINTER SOLSTICE - 21.06.2018 09:00AM

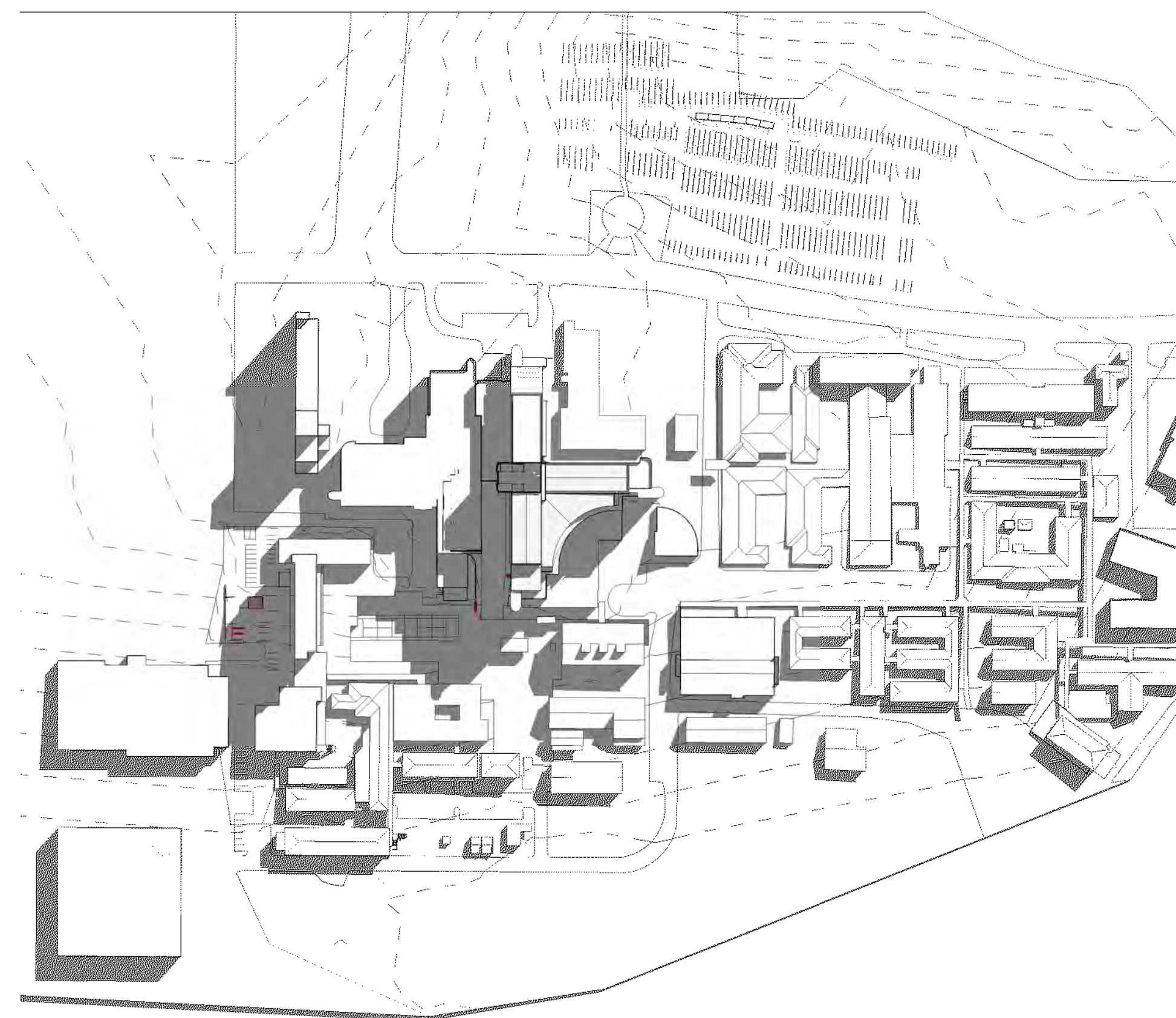

WINTER SOLSTICE - 21.06.2018 12:00PM



WINTER SOLSTICE - 21.06.2018 15:00PM

PROPOSED



WINTER SOLSTICE - 21.06.2018 09:00AM



WINTER SOLSTICE - 21.06.2018 12:00PM



WINTER SOLSTICE - 21.06.2018 15:00PM

NOTES:
TO BE READ IN CONJUNCTION WITH SERVICES, STRUCTURAL & CIVIL DOCUMENTATION. ANY DISCREPANCY TO BE BROUGHT TO THE ATTENTION OF JACOBS.

REV	DATE	BY	APPD	AMENDMENT
4	22.06.18	BY	WB	MAIN WORKS 70% DD ISSUE
3	12.04.18	BY	WB	ISSUED FOR SSKA
2	29.03.18	BY	WB	SSD - DRAFT ISSUE
1	23.02.18	MW/MR	WB	MAIN WORK 70% SD ISSUE

KEY PLAN

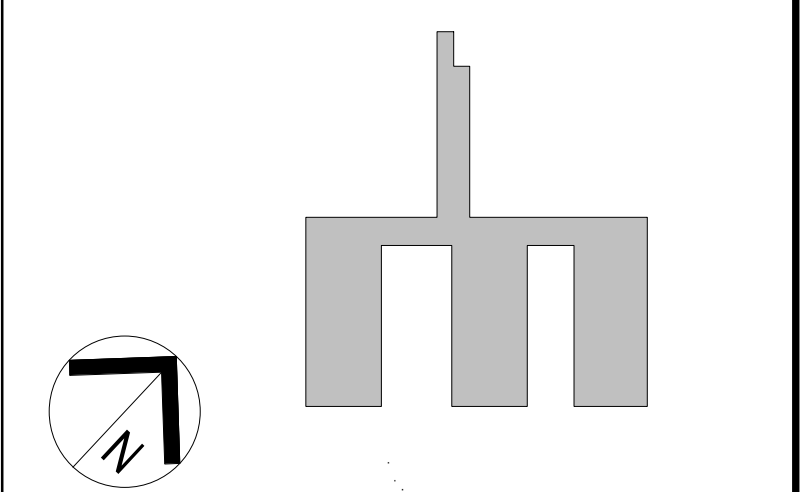

CLIENT



LEVEL 7, 177 PACIFIC HIGHWAY
NORTH STONEY
NSW 2158
AUSTRALIA
TEL: +61 2 9528 2100
FAX: +61 2 9528 2010
WEB: jacobson.com

PROJECT
**CONCORD HOSPITAL
REDEVELOPMENT STAGE 1**
HOSPITAL ROAD
CONCORD NSW 2139

TITLE
SHADOW DIAGRAM WINTER

DRAWING STATUS
SCHEMATIC DESIGN

DRAWN MR/MW/BY	DRAWING CHECK WB
DESIGNED AC	DESIGN REVIEW CY
REVIEWED	DATE
APPROVED	DATE
SCALE	

PROJECT No.	DRAWING No.	REV
IA064700	NEWB-AR-DRG-7901	4